

Fellowes

AutoMax™ 550C/350C The World's Toughest Shredders®

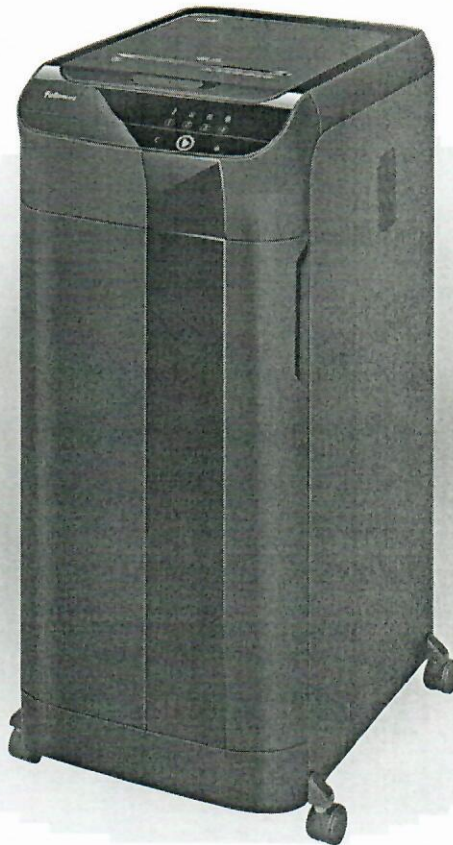

Please read these instructions before use.
Do not discard: keep for future reference.

Lire ces instructions avant utilisation.
Ne pas jeter : conserver pour référence ultérieure.

Lea estas instrucciones antes de usarlo.
No las deseche: guárdelas para tenerlas como referencia.

Diese Anleitungen vor Gebrauch genau durchlesen.
Bitte nicht entsorgen: zur späteren Bezugnahme aufheben

Prima dell'uso, si raccomanda di leggere questo manuale di istruzioni. Conservare il manuale per consultarlo secondo le necessità.

Dese instructies voor gebruik lezen. Niet weggooien, maar bewaren om later te kunnen raadplegen.

Läs dessa anvisningar innan du använder apparaten.
Släng inte bort, behåll för framtida bruk.

Læs venligst denne vejledning før anvendelse.
Bør ikke bortskaffes. Behold for fremtidig henvisning.

Lue nämä ohjeet ennen käyttöä.
Älä hävitä: säilytä myöhempää käyttöä varten.

Vennligst les nøye igjennom denne bruksanvisningen før bruk.
Ikke kast den: Ta vare på den for senere referanse.

Przed użyciem proszę zapoznać się z tą instrukcją.
Nie wyrzucać - zachować jako źródło informacji na przyszłość

Перед началом эксплуатации обязательно прочтите данную инструкцию.
Не выбрасывайте данную инструкцию: сохраните ее для последующего использования.

Παρακαλείσθε να διαβάσετε αυτές τις οδηγίες πριν χρησιμοποιήσετε το προϊόν.
Μην τις απορρίψετε: κρατήστε τις για μελλοντική αναφορά

Kullanmadan önce lütfen bu talimatları okuyun.
Atmayın: ileride başvurmak üzere saklayın.

Před použitím si přečtěte tyto pokyny.
Nelikvidujte: uschovejte pro budoucí použití.

Pred použitím si prečítajte tieto pokyny. Ne-
zahadzujte: odložte pre budúce použitie.

Kérjük, hogy használat előtt olvassa el az utasítá-
sokat!
Az utasításokat ne dobja ki; tartsa meg refer-
enciaanyagként való jövőbeni használatra.

Leia estas instruções antes da utilização.
Não as deite fora: conserve-as para consulta futura.

Pročitajte ove upute prije upotrebe.
Nemojte baciti: sačuvajte za buduću upotrebu.

Molimo da ova uputstva pročitate pre upotrebe.
Nemojte ih baciti: sačuvajte ih za ubuduće.

Моля, прочетете тези инструкции преди употреба.
Не изхвърляйте: пазете за справки в бъдеще.

Vã rugãm sã citiți aceste instrucțiuni înainte de
utilizare.
Nu aruncați: păstrați pentru o consultare ulterioară.

يرجى الاطلاع على الإرشادات قبل الاستعمال.
لا يجب التخلص من هذه الإرشادات. ويرجى حفظها للرجوع إليها في
المستقبل.

נא לקרוא הוראות אלה לפני השימוש.
אין להשליך: שמרו לעיונכם בעתיד.

ENGLISH

Model 550C/350C

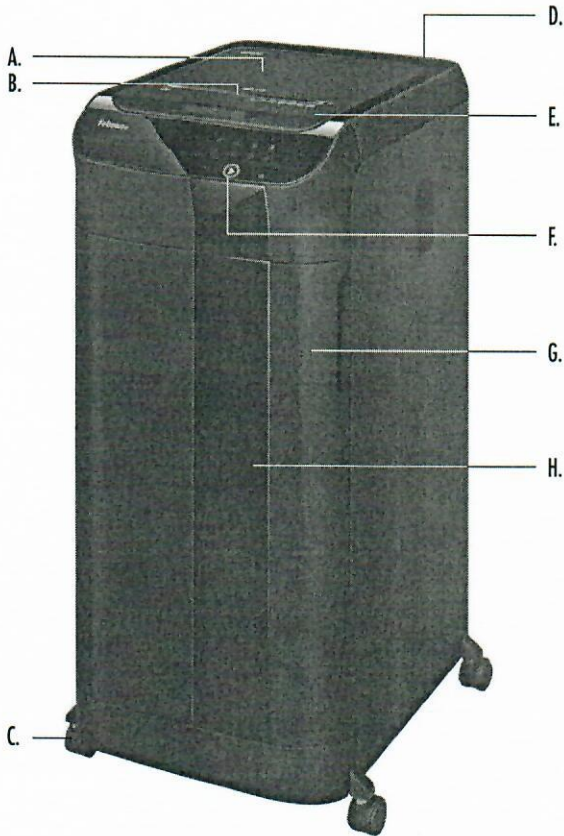

KEY FEATURES AND CONTROLS

- | | |
|----------------------------|------------------------------|
| A. Shredder Lid | E. See Safety Instructions |
| B. Manual Feed Slot | F. Control Panel (see below) |
| C. Casters | G. Bin Door |
| D. Disconnect Power Switch | H. Bin (inside) |
| ○ 1. OFF | |
| 2. ON | |

CONTROL PANEL

- | | |
|-----------------------|------------------------|
| A. Overheat (red) | F. Reverse |
| B. Remove Paper (red) | G. Start/Pause (white) |
| C. Bin Full (red) | H. Lock (white) |
| D. Bin/Lid Open (red) | |
| E. SmartLock™ pin pad | |

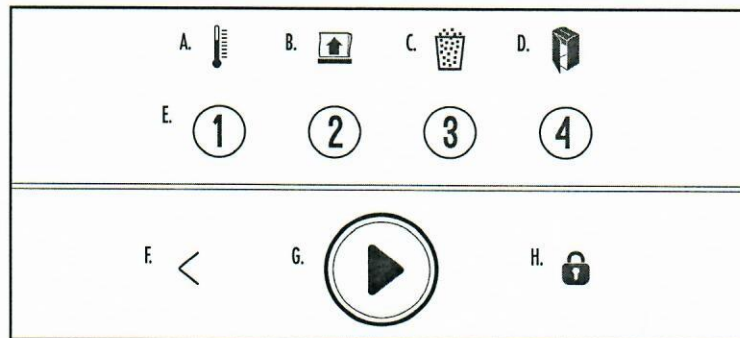

⚠ WARNING: IMPORTANT SAFETY INSTRUCTIONS — Read Before Using!

- Operation, maintenance, and service requirements are covered in the instruction manual. Read the entire instruction manual before operating shredders.
- Keep away from children and pets. Keep hands away from paper entry. Always set to off or unplug when not in use.
- Keep foreign objects – gloves, jewelry, clothing, hair, etc. – away from shredder openings. If object enters top opening, switch to Reverse (<) to back out object.
- DO NOT use aerosol products, petroleum based or aerosol lubricants on or near shredder. DO NOT USE “CANNED AIR” OR “AIR DUSTERS” ON SHREDDER. Vapors from propellants and petroleum based lubricants may combust causing serious injury.
- Avoid touching exposed cutting blades under shredder lid.
- Unplug shredder before cleaning or servicing.
- Do not use if damaged or defective. Do not disassemble shredder. Do not place near or over heat source or water.
- This shredder has a Disconnect Power Switch (D) that must be in the ON (I) position to operate shredder. In case of emergency, move switch to OFF (O) position. This action will stop shredder immediately.
- Shredder must be plugged into a properly grounded wall outlet or socket of the voltage and amperage designated on the label. The grounded outlet or socket must be installed near the equipment and easily accessible. Energy converters, transformers, or extension cords should not be used with this product.
- FIRE HAZARD – Do NOT shred greeting cards with sound chips or batteries.
- For indoor use only.

CAPABILITIES

SHRED THROUGH AUTO FEED TRAY



A4 paper



Staples



Paper clips



Up to 20 Sheets Stapled – Pull apart stapled stacks of paper containing more than 20 sheets



Up to 20 Sheets Clipped – Pull apart clipped stacks of paper containing more than 20 sheets

SHRED THROUGH MANUAL FEED SLOT



Credit cards



CD/DVD



Junk mail



Folded paper

Will not shred: Adhesive labels, continuous form paper, folded paper (Autofeed), bound documents, magazines, transparencies, newspaper, cardboard, binder clips, industrial staples, large paper clips, more than 20 pages stapled or paper clipped together, staples in top center of paper, laminates, 3½ in. Floppies, file folders, X-rays or plastic other than noted above

Paper shred size:

Cross-Cut4mm x 38mm

Maximum:

Auto Feed Sheet Capacity (550C)	550*
Auto Feed Sheet Capacity (350C)	350*
Manual Feed Sheet Capacity (550C)	14*
Manual Feed Sheet Capacity (350C)	12*

*A4 (70 g) paper at 220-240V, 50/60 Hz 2.5Amps (550C), 2.5Amps (350C); heavier paper, humidity or other than rated voltage may reduce capacity.

BASIC SHREDDING OPERATION

550C run time: continuous operation



350C run time:

Up to 45-minutes maximum. Continuous operation beyond 45-minutes will trigger 30-minute cool down period.

NOTE: Shredder runs briefly after each pass to clear entry.

AUTO FEED

** Do not open lid once shred cycle has started.*

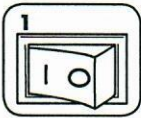

Plug in and put disconnect power switch in ON (I) position



Open lid

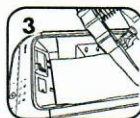

Add paper. Paper should be flat and aligned with front of paper tray.



Close lid and press start (▶) to begin shredding

MANUAL FEED

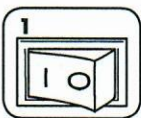

Plug in and put disconnect power switch in ON (I) position

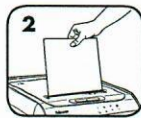

Feed paper straight into paper entry and release



Hold CD/Card at edge, feed straight into paper entry and release

Note: Manual feed cannot be used while Auto Feed in use.

*** Shredder will not run when lid is open.**

MISALIGNED PAPER

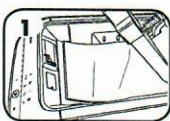

If paper is not shredding through auto feed tray, check position of paper.

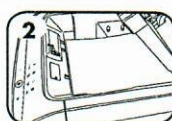

Paper should be flat and aligned with front of paper tray.

ADVANCED PRODUCT FEATURES



AUTO REVERSE

Auto Reverse
Stops and reverses paper if a jam occurs.



SMART LOCK™

SmartLock™
Engages with each shred cycle to protect confidential information.



SILENT SHRED™

SilentShred™ Technology
Shreds without noisy disruptions.



SLEEP MODE

Energy Saving Sleep Mode
Feature shuts down the shredder after 2 minutes of inactivity.



SMARTLOCK™

Optional 4-digit SmartLock™ feature keeps confidential documents secure during shredding cycle.

ENGAGE SMARTLOCK

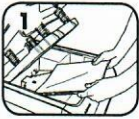

Open lid and add paper

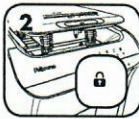

Close lid and press Lock icon



Enter 4-digit lock combination on pin pad. Drawer will lock and Lock icon on control panel will illuminate



Press start (▶) to begin shredding



When shred job is complete, Lock icon will turn off and shredder will unlock

- NOTE:**
- To unlock: press lock icon and re-enter previously set 4-digit lock combination.
 - In case of a power outage, SmartLock™ will remain engaged. Once power is restored, shred cycle will automatically resume.
 - If shredder misfeeds or jams, the shredder will unlock after 30 minutes.

For more information about all of Fellowes Advanced Product Features go to www.fellowes.com



SLEEP MODE

SLEEP MODE OPERATION

Feature shuts down the shredder after 2 minutes of inactivity

WHEN IN SLEEP MODE



To get out of sleep, open lid and load paper



or Insert paper

PRODUCT MAINTENANCE

OILING SHREDDER

All cross-cut shredders require oil for peak performance. If not oiled, a machine may experience diminished sheet capacity, intrusive noise when shredding, and could ultimately stop running. To avoid these problems, we recommend you oil your shredder each time you empty your waste bin.

FOLLOW OILING PROCEDURE BELOW AND REPEAT TWICE



Open lid



*Carefully apply oil across cutters (do not get oil in paper tray)



Close lid. Press start (▶)

CAUTION *Only use a non-aerosol vegetable oil in long nozzle container such as Fellowes 35250 

CLEANING AUTO-START INFRARED SENSORS

Paper detection sensors are designed for maintenance free operation. However, on rare occasions the sensors may become blocked by paper dust causing the motor to run even if there is no paper present.

(Note: the paper detection sensors are located in the center of the paper entry and bottom of paper tray).

TO CLEAN THE SENSORS

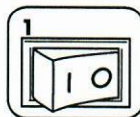

Turn off and unplug shredder



Open lid

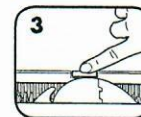

Locate Auto-start infrared sensor

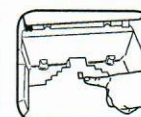

Dip cotton swab in rubbing alcohol

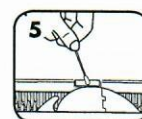

Using cotton swab, wipe away any contamination from the paper sensors



TROUBLESHOOTING



Overheat Indicator: When the Overheat Indicator is illuminated, the shredder has exceeded its maximum operating temperature and needs to cool down. This indicator will remain illuminated and the shredder will not operate for the duration of the recovery time.



Remove Paper: When illuminated, press reverse (<); open lid and remove paper.



Bin Full: When illuminated, the shredder waste bin is full and needs to be emptied. Use Fellowes waste bag 36053.



Bin/Lid Open: The shredder will not run if the bin or lid is open. When illuminated, close the bin or lid to resume shredding.

LIMITED PRODUCT WARRANTY

Limited Warranty: Fellowes, Inc. ("Fellowes") warrants the parts of the machine to be free of defects in material and workmanship and provides service and support for 2 years from the date of purchase by the original consumer. Fellowes warrants the cutting blades of the machine to be free from defects in material and workmanship for 20 years from the date of purchase by the original consumer. If any part is found to be defective during the warranty period, your sole and exclusive remedy will be repair or replacement, at Fellowes' option and expense, of the defective part. This warranty does not apply in cases of abuse, mishandling, failure to comply with product usage standards, shredder operation using an improper power supply (other than listed on the label), or unauthorized repair. Fellowes reserves the right to charge the consumers for any additional costs

incurred by Fellowes to provide parts or services outside of the country where the shredder is initially sold by an authorized reseller. ANY IMPLIED WARRANTY, INCLUDING THAT OF MERCHANTABILITY OR FITNESS FOR A PARTICULAR PURPOSE, IS HEREBY LIMITED IN DURATION TO THE APPROPRIATE WARRANTY PERIOD SET FORTH ABOVE. In no event shall Fellowes be liable for any consequential or incidental damages attributable to this product. This warranty gives you specific legal rights. The duration, terms, and conditions of this warranty are valid worldwide, except where different limitations, restrictions, or conditions may be required by local law. For more details or to obtain service under this warranty, please contact us or your dealer.

Australia Residents Only:

Our goods come with guarantees that cannot be excluded under the Australian Consumer Law. You are entitled to a replacement or refund for a major failure and for compensation for any other reasonably foreseeable loss or damage. You are also entitled to have the goods repaired or replaced if the goods fail to be of acceptable quality and the failure does not amount to a major failure. The benefits under Fellowes' Warranty are in addition to other rights and remedies under a law in relation to the shredder.